

**TO: The Cathaoirleach and Each Member of Athlone Municipal District**

**RE: Declaration of a Public Road  
Roads Act 1993, Section 11  
Roads Regulations 1994, Part 2  
Local Government Reform Act 2014 Schedule 3**

**Request for Private Road to be Taken-in-Charge: Sherlock's Road, Baylough, Athlone, Co. Roscommon**

A request was received from the residents and landowners on a private road at Monksland, Athlone (known as Sherlock's Road) to be declared a public road. Where a road is declared a public road, the Council will be responsible for the future maintenance of the road. Drawings are attached showing the road requested to be taken in charge. The declaration of a road to be a public road is a reserved function to be performed by Municipal District Members under Schedule 3 of the Local Government Reform Act 2014.

In accordance with the Roads Act 1993 Section 11 (b) Roscommon County Council has considered the following:

*(i) Satisfied itself that the road is of general public utility.*

The lands adjacent to the road are mostly in the ownership of the Sherlock family and consist of small gardens. There are three houses located on the section of road within county Roscommon. The road has been examined by Roads and Transportation technical staff and is in very bad condition and may have being surface dressed at sometime in past.

Roscommon County Council has not satisfied itself that the road is of general public utility.

*(ii) Considered the financial implications for the authority of the proposed declaration.*

The level of funding required from Department of Tourism Transport and Sport is not adequate to address the maintenance of the existing public road network. Each case would need to be evaluated individually. The council should maintain its policy of not taking private roads in charge except in exceptional circumstances. The estimated cost of the works to be carried out on the road is €40,000 and the Council would also be charged with the future maintenance of the road. In this case the Roads Section considers it a prudent policy not to spend public monies on this private road.

I do not recommend the taking in charge of this section of road within Athlone Municipal District administrative area.

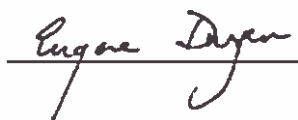

**Eugene Dwyer, Senior Engineer  
Head of Roads and Transportation  
8/3/2017.**

© Ordnance Survey Ireland. All rights reserved.  
 Licence number 2010/18CCMA  
 Roscommon County Council

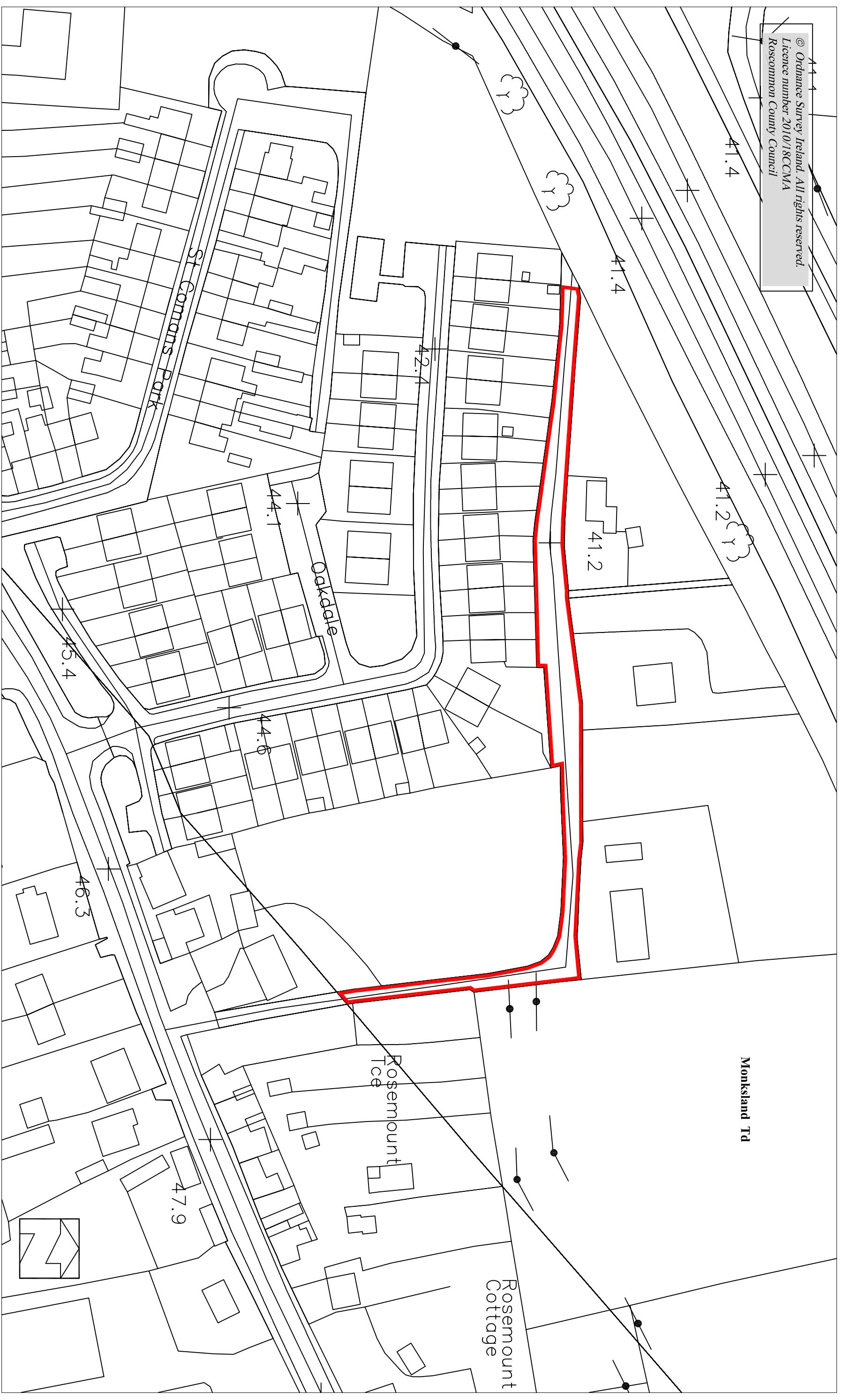

**ROSCOMMON COUNTY COUNCIL**

Road Design Section,  
 Atras an Chonraie, Roscommon,  
 Phone 090 66 37100  
 C.E.O. and Director of Service: Mr. Eugene Cummins.



Area to be Taken In Charge



**Map - Monksland Athlone.**

Project:		<b>Taken in Charge - "Monksland Athlone"</b>	
Title:		Monksland, Athlone, Co Roscommon.	
Scale:	1:2500	Date:	07/03/2017
OS Map No.	3035-D, (tm co-ords)	Checked:	
Design:	B. Earley	Contract:	
			Drawing No.: